

500⁺

Metrology meets Production

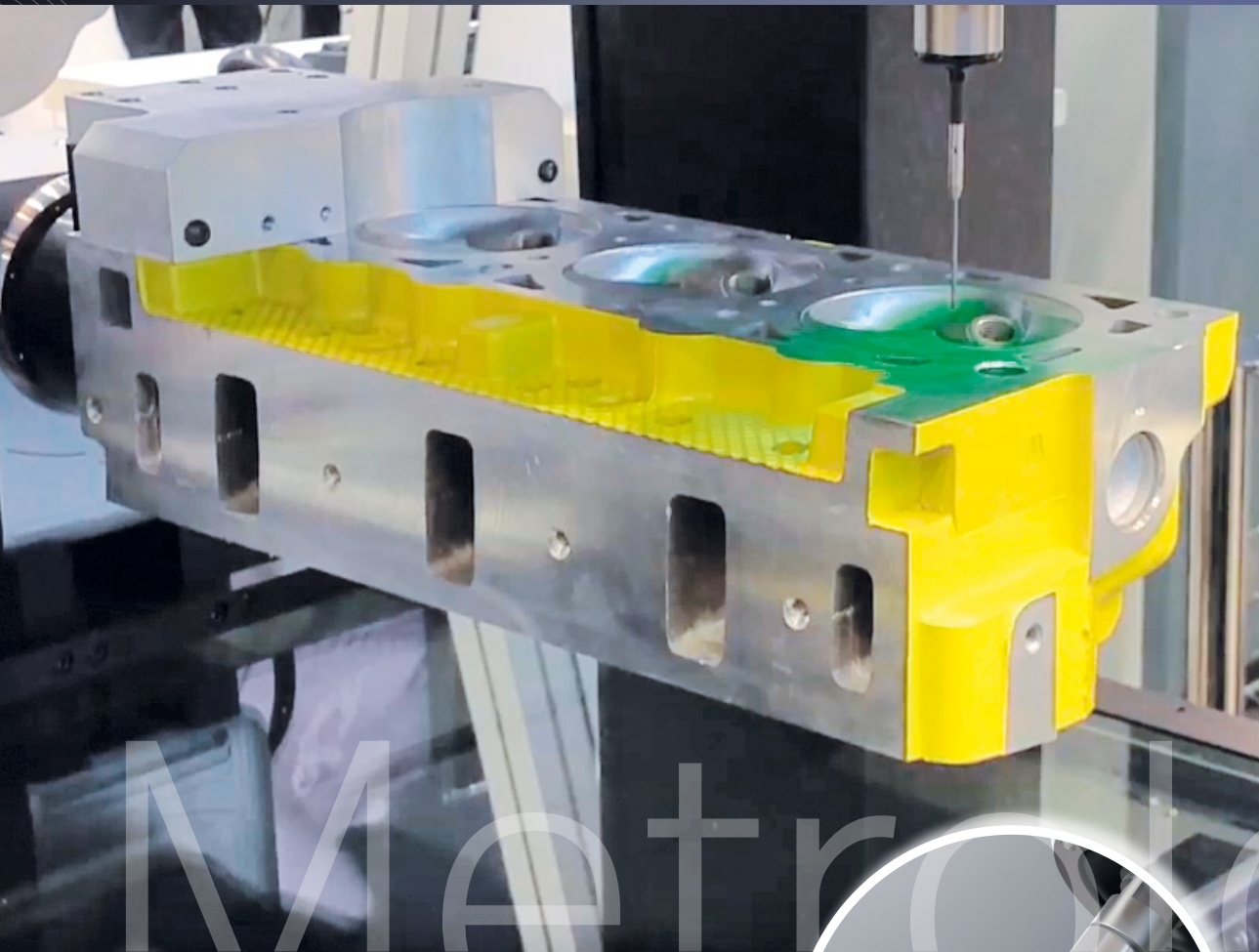

pl

Metrology

3.2019 | EN

Solutions for efficient,
industrial measurement
in modern production



The trend is obvious: Measurement technology has to move away from the measurement laboratory to production – post-line or in-line.

The measuring process is thus determined by the cycle time of the production machine. Methods that have long proven themselves in production are needed. pL LEHMANN offers them.

New challenges

- + How can workpieces be clamped during the measuring process without losing the reference point from the production machine?
- + How can workpieces be positioned as quickly, flexibly, and precisely as possible?
- + How can it be achieved that measurements are made in one clamping, similar to multi-sided machining?
- + How can measurement inaccuracies caused by vibrations and heat be kept to a minimum during simultaneous movements in space?
- + How can the measurement process be automated?



Possible on all measuring machines. With PC control and USB interface (software to be provided by the machine supplier).

pL LEHMANN rotary and swiveling axes have proven themselves in production for over 40 years. With this know-how, pL LEHMANN now offers solutions for metrology, whether in the area of coordinate metrology, multi-sensor metrology, surface metrology, contour metrology, or laser scanning. Thanks to precise and fast positioning of the workpieces, it is now also possible in measuring technology to measure efficiently and in one clamping.



Extremely wide assortment for workpiece clamping.
Standardized interface in front and rear: maximum universality

For further variants and possibilities, see the main catalog

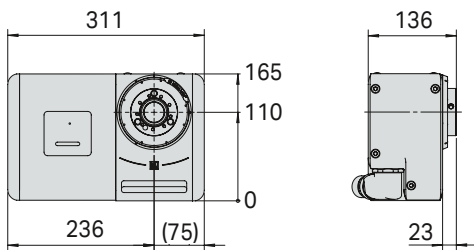

Key technical data of EA-508 light

- + Center height: 110 mm
- + Backlash-free preloaded gear unit PGD
- + Rotational speed: max. 16 rpm
- + Indexing accuracy: ± 20 (optional: up to ± 2.5) arc sec
- + Repeatability: ± 2 arc sec
- + Radial & axial concentricity: 0.006 (optional: 0.003 mm)
- + Pull-out torque: 400 Nm
- + Transport load, max. (reduced drive data!)
- + Without support: 40 kg, with support: 80 kg
- + Total weight: approx. 9.8 kg and up (depending on the size)
- + RoHS-compliant



Automation made easy! pL LEHMANN rotary and swiveling axes already have an iBox today – so they are prepared for implementation in industry 4.0

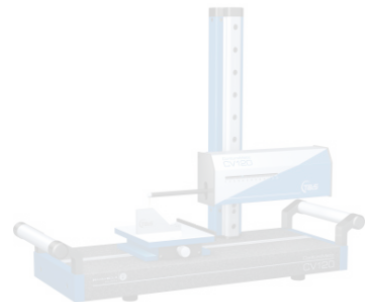
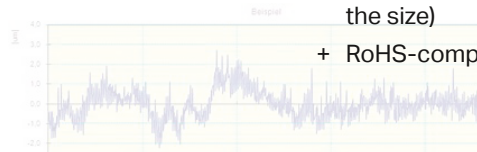

Spindle accessories (see main catalog)

pL LEHMANN rotary and swiveling axes have standard interfaces for many common clamping systems in production. The workpieces can be measured quickly and precisely without losing the reference points of the production machine.

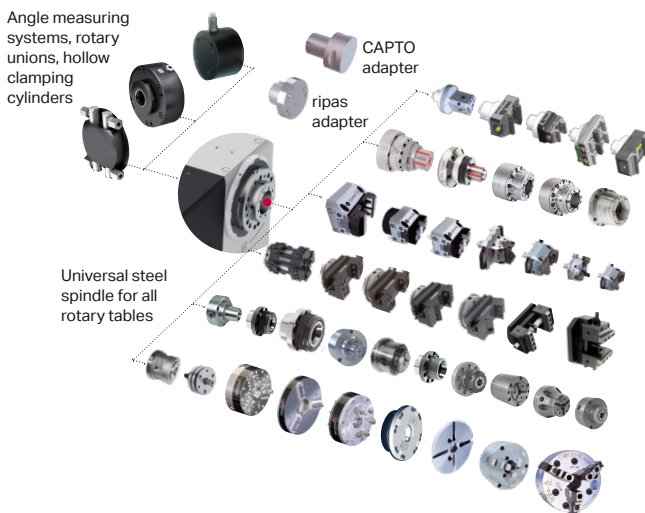



ROTARY TABLES · PRECISION TECHNOLOGY · SOFTWARE

Modularity for your future ...



Internationally positioned ... competent and customer-oriented

Headquarters PETER LEHMANN AG
CH-3552 Bärau
Phone +41 (0)34 409 66 66
Fax +41 (0)34 409 66 00
pls@plehmann.com
www.lehmann-rotary-tables.com

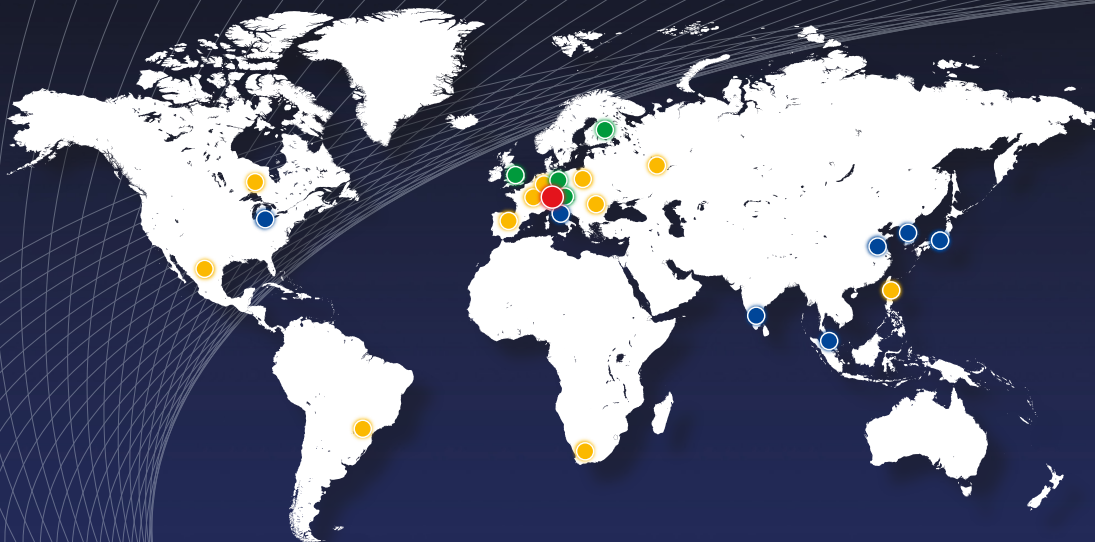

● Headquarters ● direct sales/service partner ● pL SOLUTIONS® partner ● value added reseller & partner

More information (address, telephone number...) at www.lehmann-rotary-tables.com